



USER MANUAL

Model: AL-SC30

ALILY ENERGY GmbH
www.alilyenergy.com

Portable Solar Charger 30W

Thank you for purchasing our solar charger. Before using this product for the first time, please read the instructions carefully to learn about the features and capabilities of the solar charger and how you can get the best out of it.

By product features:

- Carefully selected Mono crystalline silicon solar cells for reliable performance.
- Up to 22% high conversion rate efficiency, enabling the solar panel to produce electricity in low-lux outdoor environment (>38000Lux).
- Smart IC Technology (Intelligent Recognition Chip).
- Protection against reverse charging.

Technical Parameters

Model	AL-SC30	
Peak Power	30W	
Cell Efficiency	22%	
Power Voltage	6.6V	
Power Current	4.54A	
Open Circuit Voltage	7.92V	
Short Circuit Current	4.99A	
USB Output	5V/2.4A	
Type-C Output	5V/2.4A	
Double Output	MAX 4.8A	
Dimensions	Folded	364*188*44mm
	Unfolded	594*364*20mm
Operating Temperature Range	-10~70°C	
Net weight	1.26kgs	

User Instructions

- Unfold the solar panel. For receiving more solar radiation, please try to keep the solar panel surface at a 90 degree angle to the sunlight.

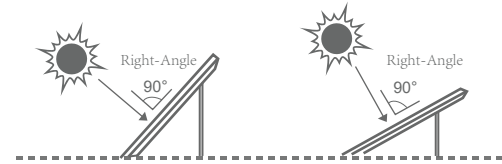

- Connect USB cable to the output port. Your solar charger can be used to charge various devices (iPhone, Android phone, Tablet and other DC-5V devices).

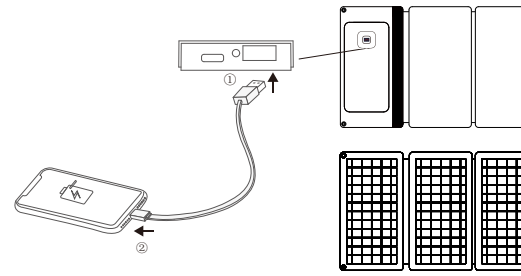

- In the output state, the red indicator light is on.

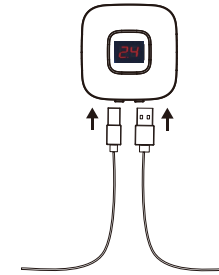

- Do not place your charging device under direct sunlight or in an overheated environment. Please place the device in the pocket of the charger or in the shade.

Package Contents

- 1 x 30W Solar Charger
- 1 x USB-TYPEC Cable
- 1 x Warranty Certificate(English - Chinese - German)
- 1 x A Pair Of Hanging Buckles
- 1 x Manual (English-Chinese)

Frequently Asked Questions

- Why aren't my electronic devices charging?

Is the output connection plugged in, or is there a cable defect?

Replug your device or replace your charging cable.

Is the solar panel facing the sunlight?

Please re-adjust the position of the solar panel to ensure enough sunlight on the panel surface.

Is the surface of the solar panel contaminated with dirt or covered with radiation blocking particles?

Clean the surface of the solar panel with a clean cloth. Remove any objects blocking the solar panel.

- Why do my electronic devices charge slowly?

Check the operating environment or weather, Power generation can be low in cloudy, rainy days.

Please replace your charging cable and try again.

Avoid placing your electronic devices under direct sunlight or in an overheated environment for a long time.

- What is the difference between the nominal output of the solar panel and the actual output?

The nominal maximum output power (rated output) of the solar cell is a value calculated by STC (Standard Test Condition, this is the World's recognized standard test condition for ground solar cell modules) in a predetermined "standard state". The "standard state" has a surface temperature of 25°C, air-mass of 1.5 and a solar intensity of 1000W/m².

Cautions

- Place the solar panel under direct sunlight. Do not cover the panel with any objects.
- Connect your device to the solar charger with the accessory cable or any other certified power cable to start the charging.
- To get maximum solar energy conversion, ensure the solar panel is placed in a vertical position to the sunlight direction.
- Keep your electronic devices out of direct sunlight. Excessive heat may cause damage.
- Do not puncture, throw, drop, bend or modify this product.
- Do not allow children to play with this product.



USER MANUAL

Model: AL-SC30

ALILY ENERGY GmbH
www.alilyenergy.com

30W 便携式太阳能充电器

感谢您购买我们的太阳能充电器,首次使用本产品前,请仔细阅读说明书,了解太阳能充电器的特性和性能,以及如何充分利用它。

产品特点:

- 精心挑选的高性能单晶硅太阳能电池片。
- 高达22%的高转换效率,使太阳能板在室外低照度环境中都能发电(>38000Lux)。
- Smart IC Technology(智能充电)。
- 反充电保护。

技术参数

型号	AL-SC30	
峰值功率	30W	
电池片转换率	22%	
工作电压	6.6V	
工作电流	4.54A	
开路电压	7.92V	
短路电流	4.99A	
USB输出	5V/2.4A	
Type-C输出	5V/2.4A	
双口输出	最大 4.8A	
尺寸	折叠	364*188*44mm
	展开	594*364*20mm
工作温度范围	-10~70°C	
净重	1.26kgs	

使用说明

- 展开太阳能电池板,为了接收更多的太阳能辐射,请您尽量使太阳能板与阳光保持90°。

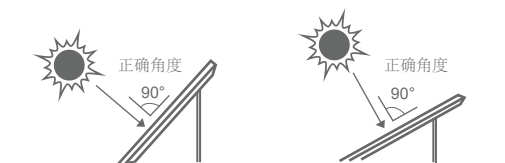

- 将USB数据线连接到输出端口,您的太阳能充电器可用于为各种(苹果、安卓手机、平板电脑和其他DC-5V设备充电)。

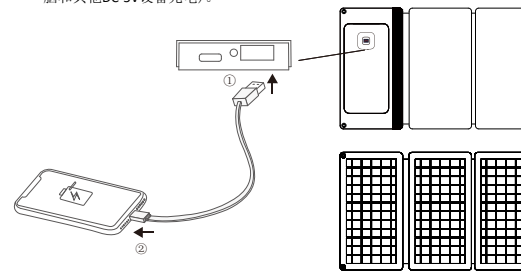

- 输出状态下,红色指示灯亮。

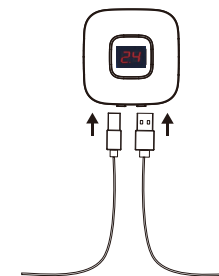

- 请勿将充电设备置于阳光直射或者过热的环境中。请您将设备置于充电器的口袋或阴凉处。

包装清单

- 1 x 30W 太阳能充电器
- 1 x USB-TYPEC线
- 1 x 保修证书(英文-中文-德文)
- 1 x 一对挂扣
- 1 x 用户手册(中英文)

常见故障及应对方案

- 为什么我的电子设备不充电?

连接是否有插入,或者电缆是否有缺陷?
重新插入您的电子设备或更换充电线。

太阳能电池板是否正对着阳光?
请重新调整太阳能的位置,确保足够的阳光照射在太阳能板表面。

太阳能板表面是否有灰尘或遮挡物?
用干净的布清洁太阳能板表面,移除任何阻挡太阳能板的物体。

- 为什么我的电子设备充电慢?

检查运行环境或天气,阴雨天发电量可能较低。
请更换充电线然后重试。

避免将您的电子设备长时间置于阳光直射或过热的环境中。

- 太阳能板标称输出功率与实际的输出功率之间有什么区别?

太阳能电池的标称输出功率(额定输出)是在STC(STC标准测试条件,这是世界公认的地面太阳能电池模块的标准测试条件)下测量得出的值。“标准测试环境”包含表面温度25°C,空气质量AM1.5,太阳光强度为1000W/m²。

注意事项

- 将太阳能电池板置于阳光直射下,不要用任何物体遮住面板。
- 使用附件电缆或其他通过认证的电源线将您的设备连接到太阳能充电器开始充电。
- 为了获得最大的太阳能转换,确保太阳能电池板垂直放置于阳光的方向。
- 让您的电子设备远离阳光直射,过热可能会导致损坏。
- 请勿刺穿,投掷,掉落,弯曲或改装本产品。
- 请勿让儿童玩此产品。